



**STURM, RUGER & Company, Inc.**

**Southport, Connecticut 06890 U.S.A. • [www.ruger.com](http://www.ruger.com)**

ALL RUGER FIREARMS ARE DESIGNED AND MANUFACTURED IN OUR OWN FACTORIES IN THE UNITED STATES OF AMERICA

## INSTRUCTIONS FOR USE OF THE LOCKING DEVICE SUPPLIED WITH YOUR NEW RUGER® FIREARM

Beginning in 2003, all newly manufactured Ruger® firearms are being shipped from the factory with a new key-operated locking device. This is a California-approved firearms safety device that meets the requirements of California Penal Code Section 12088 and the regulations issued thereunder. This new locking device is designed to help you meet your responsibility to keep your firearm stored in a safe condition. This device does not relieve the firearms owner or handler from the obligation of always paying strict attention to gun safety rules.



### WARNING – USE OF LOCKING DEVICES



- Read the owner's manual supplied with your firearm before attempting to install your locking device. (Manuals are available free online at [www.ruger.com](http://www.ruger.com) or upon request from Sturm, Ruger.)
- Always keep your firearm pointed in a safe direction, including when you are installing or removing your locking device.
- Always verify that your firearm is completely **unloaded** before installing your locking device.
- Do not install locking devices in the trigger guard; always keep your fingers, clamp and locking device outside the trigger guard during device installation and removal.
- Store firearms, ammunition and keys separately and securely, away from children and careless adults; do not store your firearm with the keys in the locking device.
- Do not attempt to work the action of your firearm with the locking device in place; this may damage your firearm.
- While locking devices are an important aid to security measures, they are not a substitute for safe firearm handling and proper storage. Remember that any mechanical device can be bypassed with enough time, knowledge, determination and equipment.

**LOCKING DEVICES MUST BE USED SAFELY AND RESPONSIBLY**

**Use the Correct Lock:** While the basic locking device is substantially similar for all Ruger® firearms, due to the different shapes of the many Ruger® firearms, some firearms require the use of a clamp (black metal bracket to which the lock is applied). This 2 1/2" lock is without a vinyl coated shackle for use with the following Ruger® firearms: New Model Blackhawk (.30 cal. *only*) single action revolvers; and SP101 (.32 cal. and .327 Fed. *only*) double action revolvers. If you were not provided a clamp, none is required. **It is very important that you use the correct locking device and clamp when locking your Ruger® firearm!**

#### **To Install the Factory-Supplied Locking Device on Your Ruger® Revolver:**

1. **Keep the muzzle pointed in a safe direction and your fingers outside the trigger guard at all times!**

— **See Other Side For Additional Instructions & Important Safety Warnings** —

**Ruger® 5025NV (2.5" x 50mm – with no vinyl coating on the shackle) – For Ruger® New Model Blackhawk (.30 cal. *only*) Single Action Revolvers; and SP101 (.32 cal. and .327 Fed. *only*) Double Action Revolvers *Only***

2. **Be sure the cylinder is completely unloaded and contains no cartridges or cartridge cases!**
3. Completely remove (single action ) or swing out (double action) the cylinder.
4. For Single Action Revolvers only, loop the shackle through the cylinder window in the frame (see Figure 1). Next slip the cylinder onto the shackle of the lock as shown in Figure 1. Skip to Instruction 6.
5. For Double Action Revolvers only, apply the lock to the cylinder as shown in Figure 2.
6. Close the lock by pressing the shackle into the body of the lock (the part that receives the key) as tightly together as possible. The lock has bumpers and the shackle is coated with a non-marring material that will not harm the metal finish of your firearm; be careful not to dent or scratch wooden stocks or grips.
7. Once the lock is securely closed, remove the key and pull firmly on the lock to test the connection and be sure it is locked. **Do not leave or store your firearm with the key in the lock!** Store your locked unloaded firearm and the key in secure, separate locations, away from ammunition, children, or unauthorized adults.

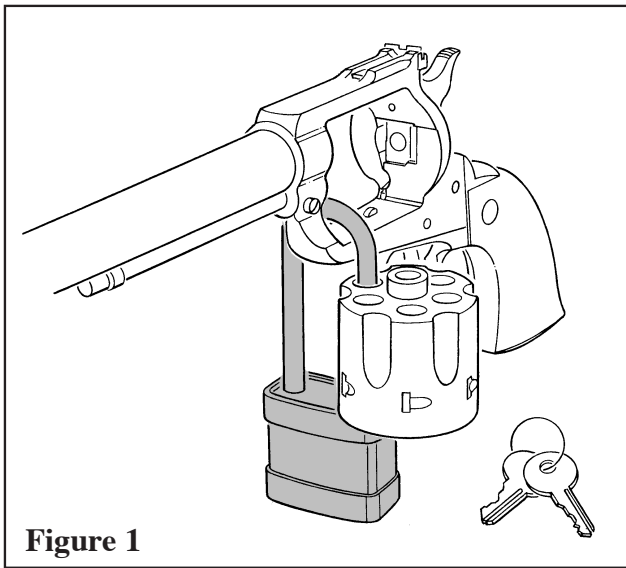

**Figure 1**

***For Ruger® New Model Blackhawk (.30 cal.)  
Single Action Revolvers Only***

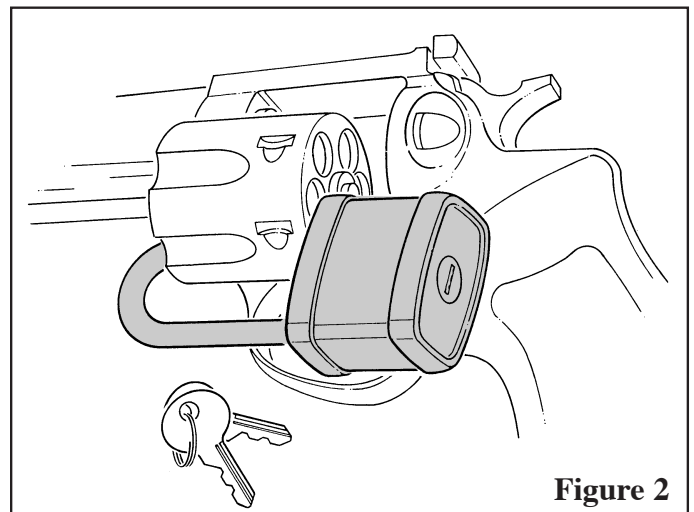

**Figure 2**

***For Ruger® SP101 (.32 cal. and .327 Fed.)  
Double Action Revolvers Only***

Remember that secure and safe firearms storage is an important responsibility that comes with your ownership of firearms. You may obtain a list of locking devices available for purchase at your local firearms retailer that have been tested and certified by California-approved laboratories for use with other firearms by contacting the California Department of Justice at (916) 322-3360 or visit their website at <http://caag.state.ca.us>. If you have any questions about what are legally appropriate locking devices in your state, or about local laws concerning safe storage requirements for firearms and ammunition, please contact your local police.